



The QOM-DC is a rectified DC power supply designed for Indoor and Outdoor LED lighting applications. The QOM-DC features five taps on the primary side to recover voltage drop.

The QOM-DC is CSA listed for Indoor and Outdoor use, as well as being rated for wet locations.

HOUSING

- 18 gauge Welded Steel Enclosure: 9.00"W x 14.5"H x 4.75"D
- Door: 9.05"W x 14.5"H
- Knockouts: 21
- Built-in support bracket incorporated to secure housing for surface mounting

FEATURES

- Suitable for dry, damp and wet locations
- Suitable for Indoor or Outdoor Use
- Suitable for Use with Submersible Luminaire
- Primary Voltage - 120V or 277V
- Loads maybe connected to one (1) of the primary taps to the full watt rating of the PSC
- 20% Derating Required
- 1-6 magnetic circuit breaker
- Five (5) primary taps provide:
 - : 11V, 12V, 13V, 14V, 15V
 - or** : 22V, 24V, 26V, 28V, 30V
- The advantage is that loads at varying distances from the PSC can be tapped to recover voltage drop and produce between 85%-100% light output
- 10 year warranty
- CSA #239924

Low Voltage Lighting Systems

- : CSA Class 3425-15 and Class 3425-95
- : CSA Standard C22.2 No. 250.0-08 - Luminaires
- : UL 2108 - Low Voltage Lighting Systems
- : CSA Standard C22.2 No. 250.13-14 - Light Emitting Diode (LED) Equipment for Lighting Applications
- : UL 8750 - Light Emitting Diode (LED) Equipment for Use in Lighting Products

Landscape Lighting Systems

- : CSA Class 3426-04 and Class 3426-94
- : CSA Standard C22.2 No. 250.7-07 - Extra-Low-Voltage Landscape Lighting Systems
- : UL 1838 - Low Voltage Landscape Lighting Systems
- : CSA Standard C22.2 No. 250.13-14 - Light Emitting Diode (LED) Equipment for Lighting Applications
- : UL 8750 - Light Emitting Diode (LED) Equipment for Use in Lighting Products

NOTE: All DC Power Supplies should be de-rated by 20%
 : DC Power Supplies may produce flicker when dimming. For optimal dimming performance, use the iQ-PH or DC+CAP products

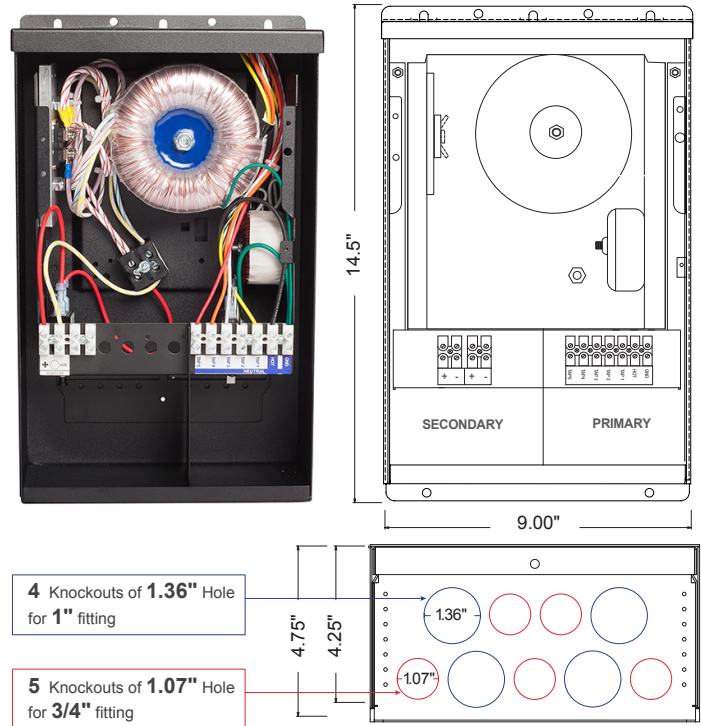

* For information on this Power Supply please consult the Q-Tran Indoor catalog or visit the Q-Tran website.

ORDERING GUIDE							
Model	1 Size	2 Prim. V	3 Sec	4 No	5 Brk Amp	6 Choke	7 Opts
QOM	-	-	/	-	x	+	+
1 Size	Max Load (Watts)	Max Energy Rating (Watts)	Max Prim. Amps @ 120V	Max Prim. Amps @ 277V			
60DC	60W	12/24	.67 A	.29 A			
100DC	100W	24	1.1 A	.49 A			
120DC	120W	12	1.3 A	.58 A			
180DC	180W	12	2.0 A	.87 A			
200DC	200W	24	2.3 A	.98 A			
240DC	240W	12	2.7 A	1.2 A			
300DC	300W	24	3.4 A	1.5 A			
360DC	360W	12	4.1 A	1.8 A			
500DC	500W	24	5.6 A	2.4 A			
600DC	600W	24	6.7 A	2.9 A			
2 Primary Voltage							
	120(60Hz)	220 (50/60Hz)*	230 (50/60Hz)*	240 (50/60Hz)*	277(60Hz)		
3 Secondary Voltage				7 Options			
	12VDC	24VDC					
4 Number of Breakers				BK Black Powder Coat Finish - Standard			
	1-6						
5 Secondary Breaker Amperage				SS* 316 Marine Grade Stainless Steel			
	AMPS	Max 12V Load	Max 24V Load				
	2.5	30W	60W				
	4	48W	96W				
	5	60W	120W				
	10	120W	240W				
	15	180W	360W				
	20	240W	480W				
	25	300W	600W				
6 Choke							CP* Cord & Plug
	CK-S: 60W-300W		CK-L: 360W-600W				
Ordering Example							
QOM-60DC - 120/12 - 1x5 + CK-S							

*Not Standard, Call Factory For options

2018.V01

PROJECT NAME	DATE	COMPANY	TYPE	NOTE

QOM-DC Power Supply (DC and DC+CAP) Installation Instructions

Must be installed by professional contractor

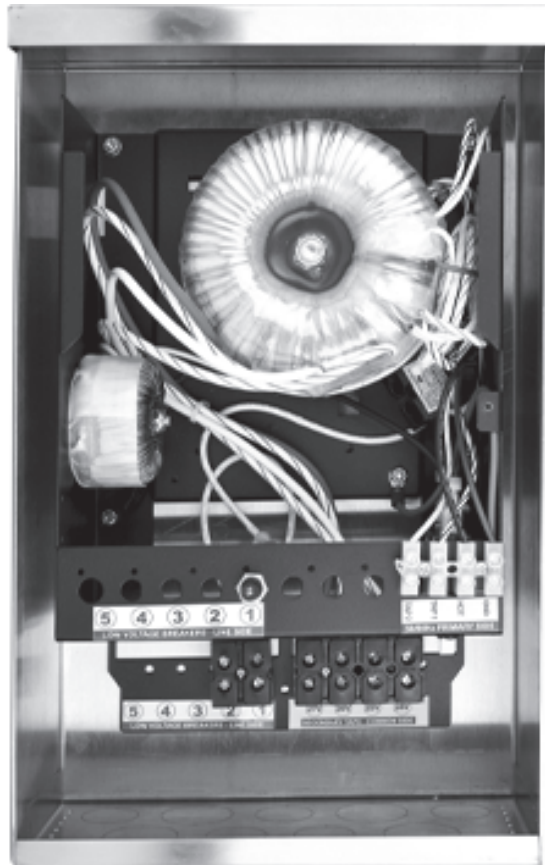

ENLIGHTENED THINKING®



ENLIGHTENED THINKING®

Installation Instructions

QOM-DC Field Wiring Made Simple

PRIMARY

Line Voltage

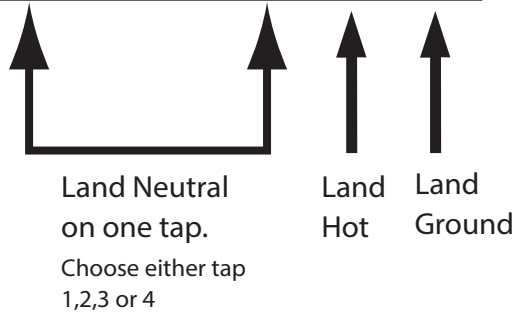
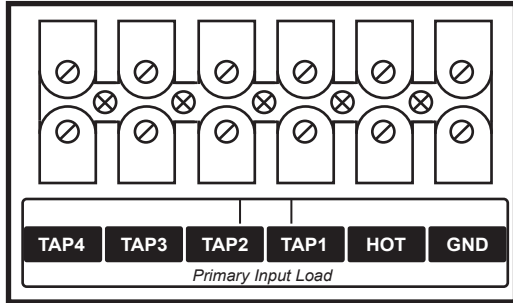

SECONDARY

Low Voltage

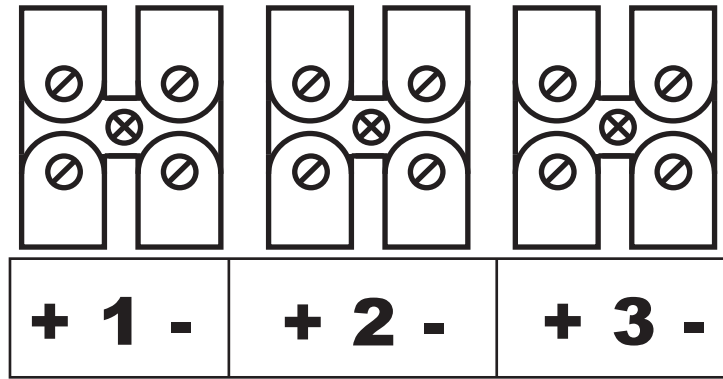

RED = Positive
YELLOW = Negative

NOTE: Primary Input - connect the 120V hot into block labeled Hot. Connect the neutral wire into Tap 1 - Tap 5 depending on desired output Voltage.(Not to exceed 12V or 24V)

QOM-DC		120VAC	230V/50Hz	277VAC	12V	24V	SECONDARY WIRE CONNECTION	
Model	Input Voltage (V)	Input Current (A)	Frequency	Nominal Output Voltage (VDC)	Nominal Output Wattage (W)	+ Red - Yellow		
QOM60	120 / 277	0.65 / 0.28	50/60	12	60			Q-Tran, Inc. 239924 CLASS: 3425 - 15 3425 - 95 Q-TRAN, INC. MILFORD, CT U.S.A. (203) 367-8777 WWW.Q-TRAN.COM
QOM120	120 / 277	1.3 / 0.6	50/60	12	120			
QOM180	120 / 277	2.0 / 0.9	50/60	12	180			
QOM240	120 / 277	2.7 / 1.2	50/60	12	240			
QOM300	120 / 277	3.4 / 1.5	50/60	12	300			
QOM60	120 / 277	0.65 / 0.28	50/60	24	60			
QOM100	120 / 277	1.1 / 0.5	50/60	24	100			
QOM200	120 / 277	2.2 / 1.0	50/60	24	200			
QOM300	120 / 277	3.4 / 1.5	50/60	24	300			
QOM500	120 / 277	5.6 / 2.4	50/60	24	500			
QOM600	120 / 277	6.7 / 2.9	50/60	24	600			

This product must be installed in accordance with the applicable installation code by a person familiar with the construction and operation of the product and the hazards involved.

- WALL MOUNT ONLY
- SUITABLE FOR DAMP LOCATIONS
- 50/60 CYCLE A.C. ONLY
- FOR SUPPLY CONNECTIONS USE WIRE RATED FOR AT LEAST 75 C.
- USE DIMMERS RATED FOR MAGNETIC LOW VOLTAGE LOAD
- MADE IN THE U.S.A.
- ISOLATION TOROIDAL TRANSFORMER

LOW VOLTAGE LUMINAIRE POWER SUPPLY CENTER

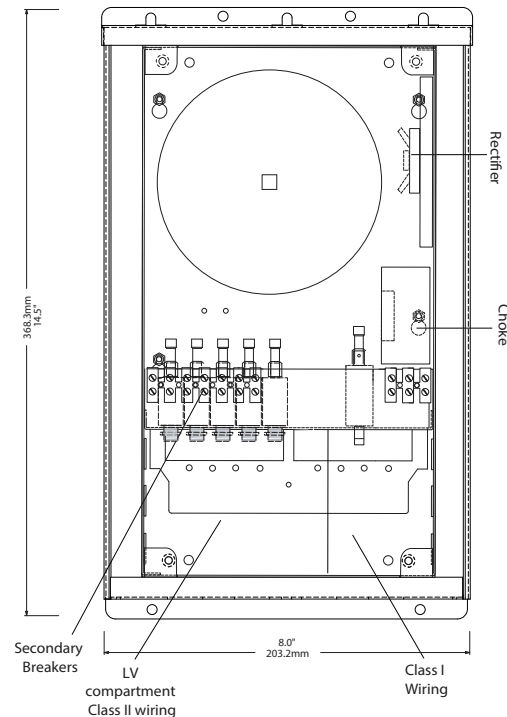

Must test all voltage readings with a True RMS Voltage Meter.

Installation Instructions



ENLIGHTENED THINKING®

QOM-DC+CAP Field Wiring Made Simple

PRIMARY

Line Voltage

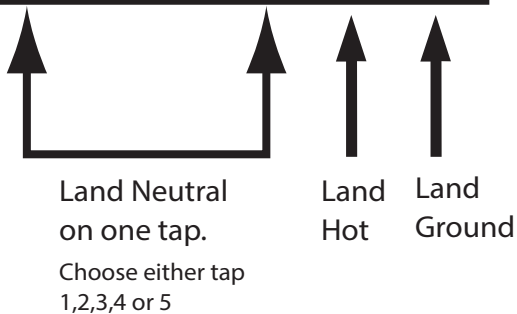
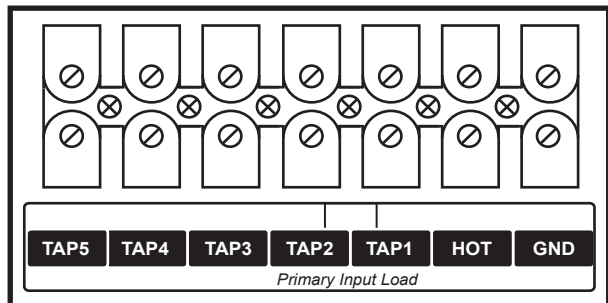

SECONDARY

Low Voltage

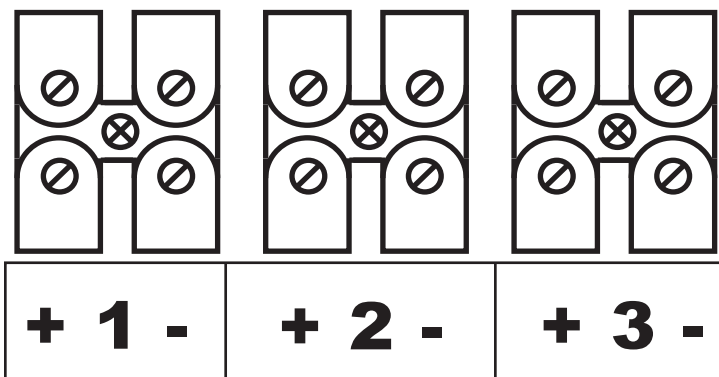

RED = Positive
YELLOW = Negative

NOTE: Primary Input - connect the 120V hot into block labeled Hot. Connect the neutral wire into Tap 1 - Tap 5 depending on desired output Voltage.(Not to exceed 12V or 24V)

QOM-DC+CAP		120VAC	230V/50Hz	277VAC	12V	24V	SECONDARY WIRE CONNECTION	
Model	Input Voltage (V)	Input Current (A)	Frequency	Nominal Output Voltage (VDC)	Nominal Output Wattage (W)	+ Red - Yellow		
QOM60DC+CAP	120 / 277	0.9 / 0.4	50/60	12	60			Q-TRAN, INC. MILFORD, CT U.S.A. (203) 367-8777 WWW.Q-TRAN.COM
QOM100DC+CAP	120 / 277	1.4 / 0.6	50/60	12	120			
QOM120DC+CAP	120 / 277	0.9 / 0.4	50/60	24	60			
QOM200DC+CAP	120 / 277	1.3 / 0.5	50/60	24	100			
QOM200DC+CAP	120 / 277	2.4 / 1.0	50/60	24	200			

This product must be installed in accordance with the applicable installation code by a person familiar with the construction and operation of the product and the hazards involved.

LOW VOLTAGE LUMINAIRE POWER SUPPLY CENTER

- WALL MOUNT ONLY
- SUITABLE FOR DAMP LOCATIONS
- FOR SUPPLY CONNECTIONS USE WIRE RATED FOR AT LEAST 75 C.
- USE DIMMERS RATED FOR MAGNETIC LOW VOLTAGE LOAD
- 50/60 CYCLE A.C. ONLY
- ISOLATION TOROIDAL TRANSFORMER
- MADE IN THE U.S.A.

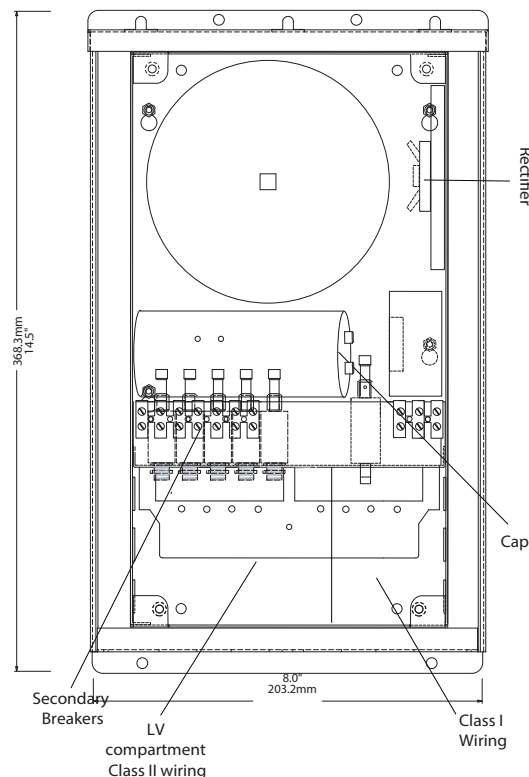

Must test all voltage readings with a True RMS Voltage Meter.