



The QOM-DC is a rectified DC power supply designed for Indoor and Outdoor LED lighting applications. The QOM-DC features five taps on the primary side to recover voltage drop.

The QOM-DC is CSA listed for Indoor and Outdoor use, as well as being rated for wet locations.

HOUSING

- 18 gauge Welded Steel Enclosure: 9.00"W x 14.5"H x 4.75"D
- Door: 9.05"W x 14.5"H
- Knockouts: 21
- Built-in support bracket incorporated to secure housing for surface mounting

FEATURES

- Suitable for dry, damp and wet locations
- Suitable for Indoor or Outdoor Use
- Suitable for Use with Submersible Luminaire
- Primary Voltage - 120V or 277V
- Loads maybe connected to one (1) of the primary taps to the full watt rating of the PSC
- 20% Derating Required
- 1-6 magnetic circuit breaker
- Five (5) primary taps provide:
 - : 11V, 12V, 13V, 14V, 15V
 - or** : 22V, 24V, 26V, 28V, 30V
- The advantage is that loads at varying distances from the PSC can be tapped to recover voltage drop and produce between 85%-100% light output
- 10 year warranty
- CSA #239924

Low Voltage Lighting Systems

- : CSA Class 3425-15 and Class 3425-95
- : CSA Standard C22.2 No. 250.0-08 - Luminaires
- : UL 2108 - Low Voltage Lighting Systems
- : CSA Standard C22.2 No. 250.13-14 - Light Emitting Diode (LED) Equipment for Lighting Applications
- : UL 8750 - Light Emitting Diode (LED) Equipment for Use in Lighting Products

Landscape Lighting Systems

- : CSA Class 3426-04 and Class 3426-94
- : CSA Standard C22.2 No. 250.7-07 - Extra-Low-Voltage Landscape Lighting Systems
- : UL 1838 - Low Voltage Landscape Lighting Systems
- : CSA Standard C22.2 No. 250.13-14 - Light Emitting Diode (LED) Equipment for Lighting Applications
- : UL 8750 - Light Emitting Diode (LED) Equipment for Use in Lighting Products

NOTE: All DC Power Supplies should be de-rated by 20%
 : DC Power Supplies may produce flicker when dimming. For optimal dimming performance, use the iQ-PH or DC+CAP products

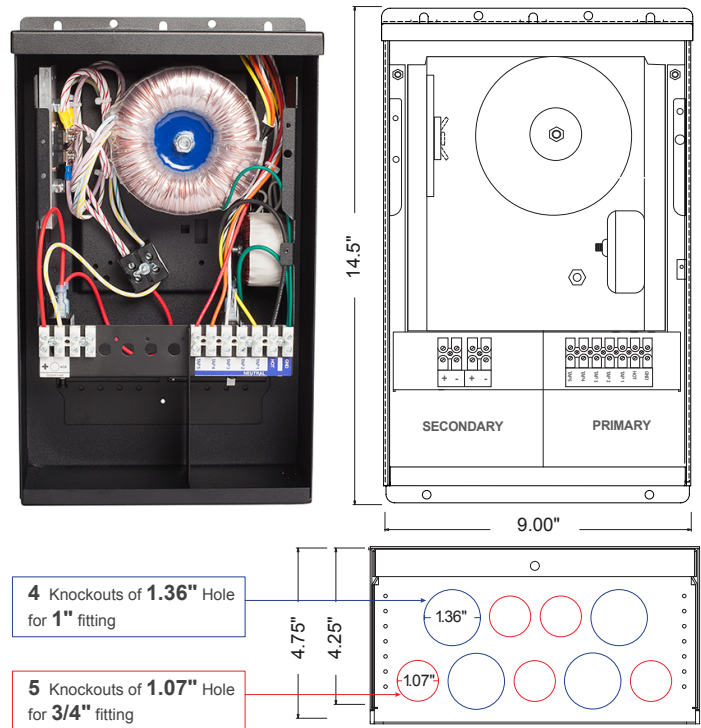

* For information on this Power Supply please consult the Q-Tran Indoor catalog or visit the Q-Tran website.

ORDERING GUIDE							
Model	1 Size	2 Prim. V	3 Sec	4 No	5 Brk Amp	6 Choke	7 Opts
QOM	-	-	/	-	x	+	+
1 Size	Max Load (Watts)	Max Energy Rating (Watts)	Max Prim. Amps @ 120V	Max Prim. Amps @ 277V			
60DC	60W	12/24	.67 A	.29 A			
100DC	100W	24	1.1 A	.49 A			
120DC	120W	12	1.3 A	.58 A			
180DC	180W	12	2.0 A	.87 A			
200DC	200W	24	2.3 A	.98 A			
240DC	240W	12	2.7 A	1.2 A			
300DC	300W	24	3.4 A	1.5 A			
360DC	360W	12	4.1 A	1.8 A			
500DC	500W	24	5.6 A	2.4 A			
600DC	600W	24	6.7 A	2.9 A			
2 Primary Voltage							
120(60Hz) 220 (50/60Hz)* 230 (50/60Hz)* 240 (50/60Hz)* 277(60Hz)							
3 Secondary Voltage					7 Options		
12VDC 24VDC					BK Black Powder Coat Finish - Standard		
4 Number of Breakers					SS* 316 Marine Grade Stainless Steel		
1-6					CP* Cord & Plug		
5 Secondary Breaker Amperage							
AMPS		Max 12V Load	Max 24V Load				
2.5	30W	60W					
4	48W	96W					
5	60W	120W					
10	120W	240W					
15	180W	360W					
20	240W	480W					
25	300W	600W					
6 Choke							
CK-S: 60W-300W CK-L: 360W-600W							
Ordering Example							
QOM-60DC - 120/12 - 1x5 + CK-S							

*Not Standard, Call Factory For options

2018.V01

PROJECT NAME	DATE	COMPANY	TYPE	NOTE